

STEEL GRATING OVERVIEW AND APPLICATIONS



STEEL GRATING PRODUCT CODING

Example: 25 x 5 / 1 = 255 / 1

Load bar depth Load bar thickness Load bar pitching

Series 1 = 30mm centres

Series 2 = 40mm centres

Series 3 = 60mm centres

- The most common size bar thickness range from 20mm up to 65mm. If a larger size is required please contact us.
- Steel Grating Limited provides both plain and serrated styles of aluminium and mild steel grates. Plain grating is used in most applications, but we also provide a serrated top grating (where notches are taken out of the top of the flat bars to aid traction in slippery conditions).

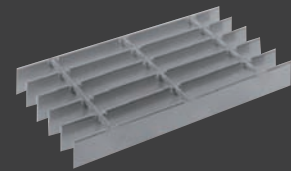

Plain Surface

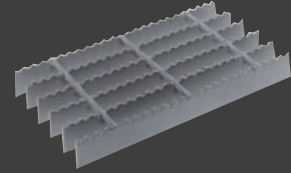

Optional Serrated Surface

STEEL GRATING STANDARD SHEET SIZES

Our grating is manufactured to the following sizes. From this we can cut to any size to suit your requirements.

Mild steel - 5800mm (load bar) x 1000mm

Aluminium - 5000mm (load bar) x 1000mm

F.R.P 1220mm x 3660mm

Some F.R.P Sheets are available in 1220mm x 2440mm

STEEL GRATING FINISHES

- Steel Grating Limited products can come in a variety of finishes:
- Mild Steel - Black (untreated) or galvanized
- Aluminium - Mill, anodized or powder coated
- F.R.P - Isophthalic polyester. (This is standard but many other options are available upon request).

STEEL GRATING LOAD BAR DIRECTION

It is important to check the direction of the load bars when ordering steel grating.

Diagram to the right shows the right and wrong way of the load bar direction.

The left diagram shows the correct way to order steel grating. The load bar takes the weight on top of the support. The diagram on the right shows the incorrect way to order steel grating. Here the cross bars are taking the weight of the load and the panel will collapse under pressure due to the lack of support under the load bars. The load bar must simply be supported at its outer most edges.

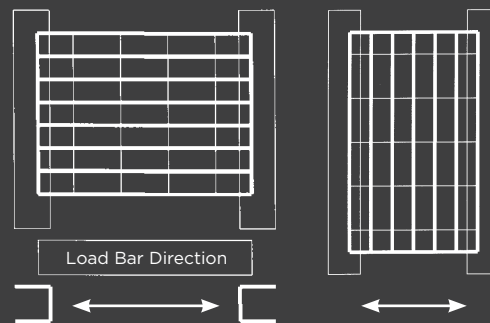

STEEL GRATING AVAILABILITY

At steel grating it is important for us to get the job completed within your required timeline. Sometimes deadlines can be tight and when requested we can go the extra distance to ensure you deliver the job on time.

STEEL GRATING APPLICATIONS

Steel grating can be used in a wide range of applications such as

- Flooring
- Stair treads
- Sun shades
- Drain covers
- Security screens
- Man hole covers
- Mezzanine flooring
- Earth mats
- Shelving
- Stanchions (hand rails)
- And many other applications as well

STEEL GRATING SPACING TABLE

PLEASE NOTE: Spaces are for 5mm thick bars. For 3mm bars minus 2mm of each spacing.
 Example - 4 bars series 1 for 3mm = 93mm.

This table shows the spacing between the load bars for each of the three grating series we provide. When ordering, please keep these spacings in mind so we can cut the grating to the nearest load bar - this makes the final product look aesthetically pleasing.

Number of bars:	SERIES 1: 30mm Pitch, Bars 5mm	SERIES 2: 40mm Pitch, Bars 5mm	SERIES 3: 60mm Pitch, 5 mm Bars
2	35	45	65
3	65	85	125
4	95	125	185
5	125	165	245
6	155	205	305
7	185	245	365
8	215	285	425
9	245	325	485
10	275	365	545
11	305	405	605
12	335	445	665
13	365	485	725
14	395	525	785
15	425	565	845
16	455	605	905
17	485	645	965
18	515	685	
19	545	725	
20	575	765	
21	605	805	
22	635	845	
23	665	885	
24	695	925	
25	725	965	
26	755	1005	
27	785		
28	815		
29	845		
30	875		
31	905		
32	935		
33	965		
34	995		

